



[www.arkimarine.com](http://www.arkimarine.com)

# Index

## 1. Arki Group Overview

## 2. Arki Marine Overview

## 3. Our Partners

## 4. Our Services

- Bio Diverse Solutions
- Marine Capabilities
- Marine Art Creations

## 5. Solutions

- Floating Pools
- Other Floating Solutions
- Customized Solutions

## 6. Our Products

- Marine Collection
- Home Collection
- EasyWay
- Design Build Aluminum
- Beach Cleaning Machines / Services
- Inflatable Water Products

# Arki Group Overview

**ARKI Group** Leading Interior Design and Fitout Company specialize in contracting, manufacturing, and multi-trade specialist in design-build solutions. We cater to our clients' fit-out needs with large-scale manufacturing capabilities and an unwavering commitment to delivering innovative turnkey projects. Our industry-specialized team of skilled workmen, engineers, and superintendents, backed by effective management, collaboratively works by interchanging knowledge and expertise to meet each of our client's specs while maintaining ARKI's renowned high-quality product and safety standards.

**1996**  
In MENA

**9**  
Subsidiaries

**3000+**  
Projects

**500+**  
Professionals

**1M+**  
Innovative  
Interior Spaces



## Arki Marine Overview

**ARKI Marine**, established in 2024 as a division of **ARKI Group**, is a premier marine and coastal infrastructure contractor, delivering innovative floating solutions and comprehensive coastal management services. We specialize in designing, constructing, and managing diverse marine structures like aluminum bridges, gangways, and custom floating platforms, including marinas and pools. Our expertise also encompasses coastal erosion control, shoreline stabilization, and sustainable development, supported by a range of high-quality marine products.



## Our Partners



**Bluet** specializes in sustainable, custom floating solutions like pools, beach clubs, and villas that transform waterfronts into vibrant, functional spaces, including landmark projects like the world's largest floating infinity pool.



**Sea & Symphony** designs and manufactures custom-engineered automated lifts, brackets, and TV mounts for marine and residential use, offering reliable motorized solutions like TV lifts, rotating mounts, and flip-down systems built for safety and precision.



**Aguacarbon** creates high-performance carbon fiber components for the marine industry by blending cutting-edge automotive and aerospace technologies with a deep passion for the sea.



**MAADI Group** is a Canadian aluminum engineering firm known for durable, low-maintenance structures such as pedestrian bridges, marinas, and floating docks designed for long-lasting performance and minimal environmental impact.



**Tuareg** is an Italian company with over 20 years of experience producing CE-certified, patented beach cleaning machines built from high-quality, hot-dip galvanized materials offering durable, reliable solutions with a strong focus on clarity, flexibility, and accessibility.



**Wibit** is a global leader in modular inflatable water parks, delivering safe, innovative, and fully customizable aquatic experiences to over 70 million users across 100+ countries, backed by German engineering, TÜV certification, and a strong focus on quality, reliability, and long-term value.



# OUR SERVICES

## Bio Diverse Solutions



### Seawalls and Revetments

We approach each coastline as a distinct ecosystem, developing customized solutions that safeguard both our clients' interests and the surrounding environment. Our innovative, site-specific methods ensure the preservation of coastal beauty and integrity, distinguishing us in coastal protection and management.



### Groynes

Groynes are commonly used to manage shorelines by trapping coastal sediments. Our team of coastal experts understands these processes and their effects, offering practical and cost-effective solutions for groyne installation. With reliable experience, we provide effective shoreline management while prioritizing the protection of the coastal environment.



### Artificial Reefs & Breakwaters

Specialize in consulting, design, and project management for artificial reefs and breakwaters. By utilizing innovative artificial reef solutions, we help protect coastlines, create dive attractions, and restore marine habitats, offering customized approaches for various coastal and marine needs.

## Bio Diverse Solutions



### Dredging & Nourishment

We handle the design, supervision, and management of international dredging and nourishment projects, ensuring project goals are achieved while respecting the environment, aesthetics, and community values. Our focus is on creating a balance between functionality and care for the surrounding ecosystem and local communities.



### Sand-Filled Containers

Sand-filled Geotextile Containers (SFGCs) offer a sustainable alternative to traditional coastal protection materials like rock and concrete. With expertise in designing and applying SFGCs, Ensure optimal performance and tailored solutions that maximize our Clients' outcomes in coastal protection projects.



### Marine Facilities

Focusing on agile project management and seamless coordination across different disciplines to deliver top-quality marine facilities. Our aim is to ensure every project is completed smoothly and successfully, always keeping the best outcomes for our clients in mind.

## Marine Capabilities

At Arki Marine, we specialize in designing and constructing state-of-the-art floating marinas and swimming pools, transforming aquatic spaces into luxurious retreats. Imagine a floating marina with an infinity sea pool that seamlessly blends with the horizon, creating an atmosphere of tranquility and elegance. Our marinas feature essential amenities, such as gourmet restaurants and private cottages that provide serene getaways, allowing guests to relax and reconnect with nature.

Prioritizing sustainability and innovation to enhance coastal environments while delivering exceptional recreational experiences. We offers tailored solutions for private residences, resorts, and commercial developments. Explore our diverse offerings, including jetty marinas, floating swimming pools, combined integrated jetty marinas and floating swimming pools, and boat dry docks, and turn your luxury marine living dreams into reality.

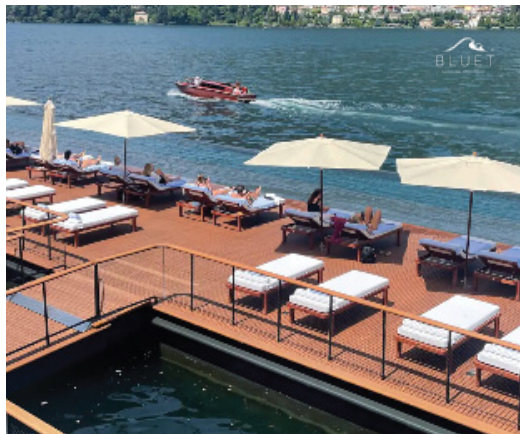
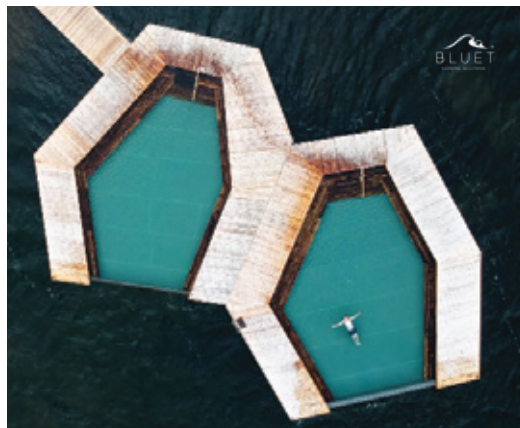

## Marine Art Creations

Marine Art Creations, a specialized service of Arki Marine, is dedicated to designing, fabricating, and installing captivating marine art that harmonizes with the ocean environment. Drawing on Arki Marine's decades of expertise in engineering, construction, and environmental stewardship, our integrated team delivers unique and sustainable artistic experiences. From conceptual design to custom fabrication and seamless installation, we transform coastal and marine spaces with sculptures, installations, and eco-friendly souvenirs. Committed to sustainability, we use environmentally responsible materials and methods, support ocean conservation, and enrich communities through public art. By combining creative innovation with technical excellence, Marine Art Creations enhances aesthetics, promotes awareness, and provides a streamlined, impactful experience.



# Solutions

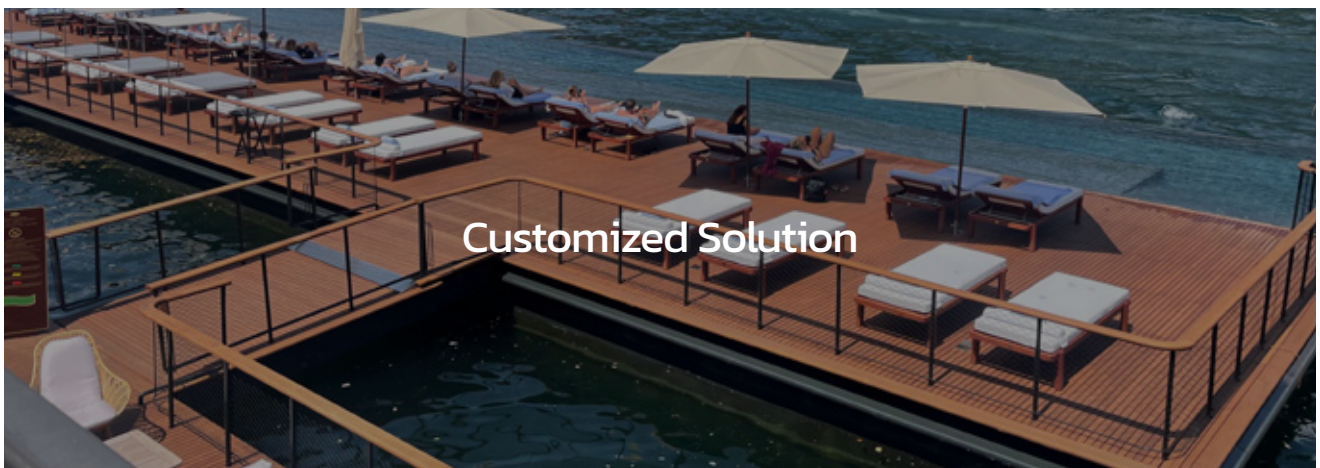
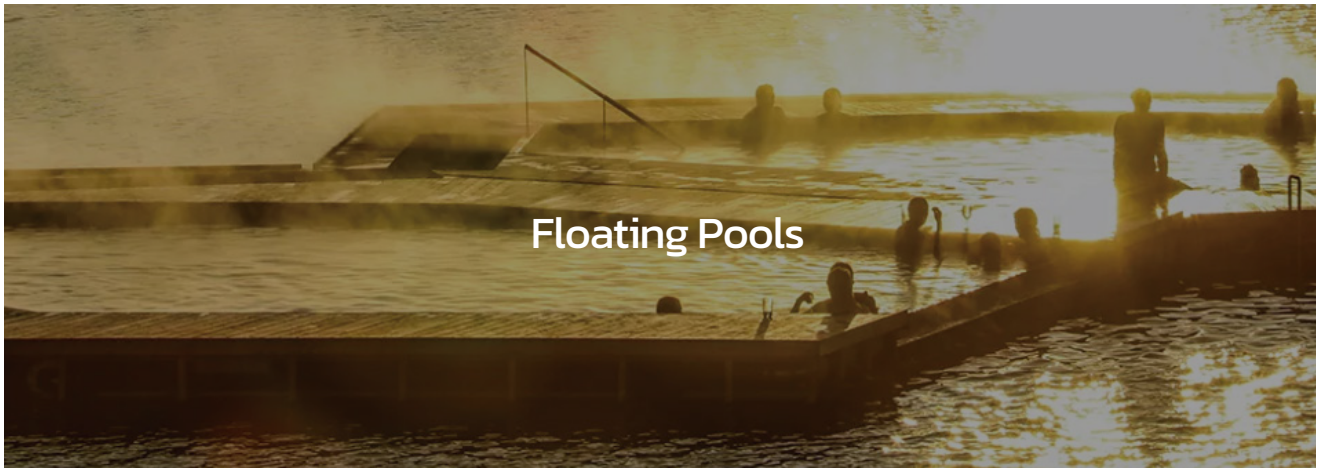

# Floating Pools



## Heated Pools

≡ Multiuse Pools

└ Barge Pools

## Natural Water Pools

# Grated Pools

□ Bottomless Pools

## Customized Pools

Our team of experts will gladly assist you in putting together an ideal plan for your pool.



Floating pools offer a unique and versatile swimming experience, blending innovation with functionality. Options like heated pools, including multiuse pools and barge pools, provide comfort and adaptability for various needs. For a natural touch, natural water pools such as the grated NET pool and the striking bottomless pool immerse swimmers in an authentic aquatic environment. Additionally, customized pools cater to individual preferences, ensuring a tailored and exclusive design for every user. These diverse pool options not only enhance aesthetic appeal but also provide a perfect blend of relaxation, recreation, and luxury to suit any lifestyle.

## Heated Pools

## Floating Pools



Whether you are looking for a pool for sports & exercise or rest & relaxation purposes or even for a combination of those, Bluet's selection and comprehensive knowledge of heated pools ensure the most purposeful outcome. Heated pools are ideal for versatile needs and year round use. The water temperature can be adjusted to client preferences, which usually varies from + 27° Celsius up to thermal spa pool temperatures. We will help you choose the best option and guide you through all stages of design and implementation.

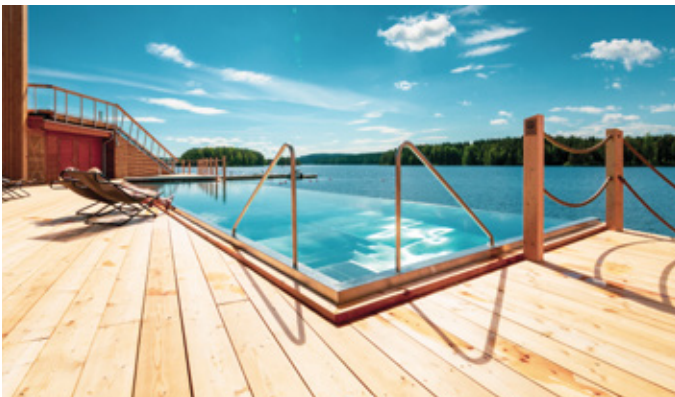

### ≡ Multiuse Pools

The multiuse pool is ideal for various purposes, catering to different operational needs and clientele. It transitions seamlessly from a children's wading pool or swimming school venue to a stylish spa or nightclub chilling pool with the right deck & lighting.



### ∩ Barge Pools

Barge pools combine advanced architecture and technology, offering customizable heated pools with unobstructed views and scalable options like infinity edges and competition sizes per FINA regulations. Ideal for unique underwater facility requirements.

## Natural Water Pools

## Floating Pools



Swimming in natural, free-flowing water is a unique experience. Our technology makes it possible even in areas with poor water quality. Their natural water pools float and allow water to run freely while filtering when needed. These pools utilize surrounding water and offer options like bottomless or grated designs. Grated pools include a bottom and a separate filtering system if required. Bluet's solutions adapt to individual needs and locations seamlessly



### # Grated Pools

The grated pool, part of Bluet's modular floating pool family, uses surrounding water and features a stainless-steel frame with a micro mesh fiberglass cover. Serving as a wading pool, lap pool, jumping pool, or chill-out pool with ambient lights and seating.



### □ Bottomless Pools

A bottomless swimming pool is a simple, sheltered solution featuring a floating platform with safety nets and optional features like solar decks, railings, and lighting. Sizes range from 3.0 x 5.8m to 14.2 x 50.0m, catering to various needs.

## Other Floating Solutions



we emphasize that well-planned floating infrastructure is the unseen, yet critical foundation beneath every successful floating project. Whether it's a serene floating pool or a bustling floating restaurant, our tailored infrastructural solutions ensure stability and sustainability in any environment.



- **Sports, Entertainment and Leisure Facilities**
- **Lightweight Solutions for Marinas and other Utility needs**
- **Hospitality and Housing Units**
- **Pools and Large Floating Multiconcepts**

## Customized Solutions



Customized pools give more freedom to the design and they allow more creativity to your pool project. In addition to standard modules, features and accessories, customized pools can have more shapes, styles, additional luxurious features and special needs for end-use.

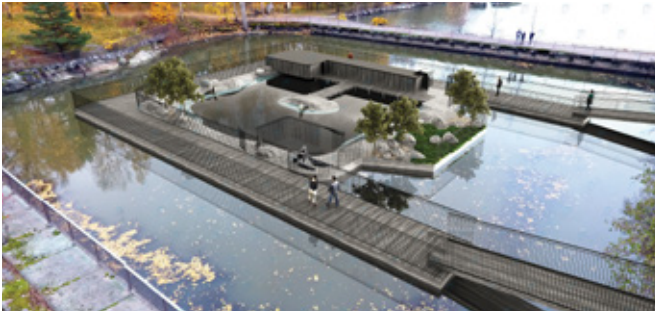

- **Floating Zoo Pool**
- **Twin Thermal Spa Pools**
- **Aquarium with a Pool**
- **Massive Private Or Public Swimming Arena**



# OUR PRODUCTS



# Marine Collections



The Most complete and innovative range of Products dedicated to the interiors of boats, Yachts, and Cruise Ships

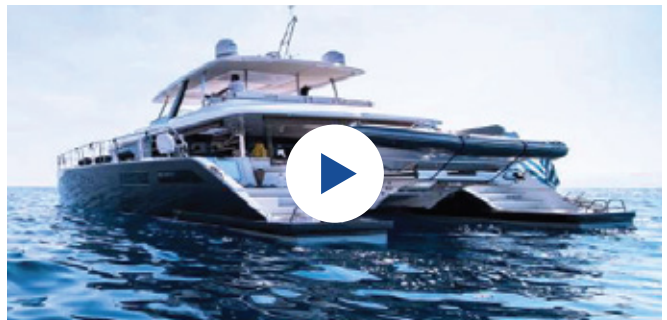

TV Lifts

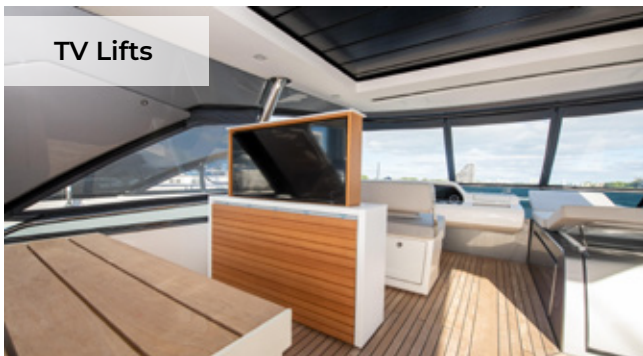

Rotating TV Mounts



Flip Down TV

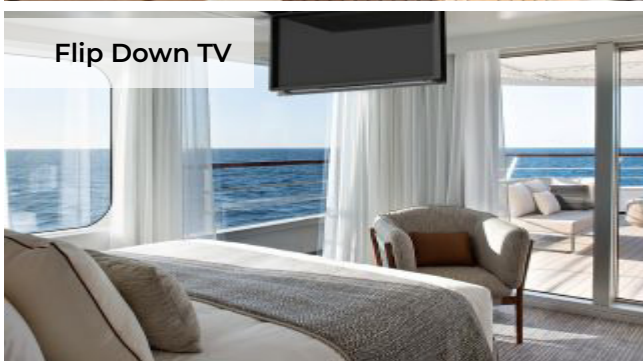

TV Concealed in the Wall

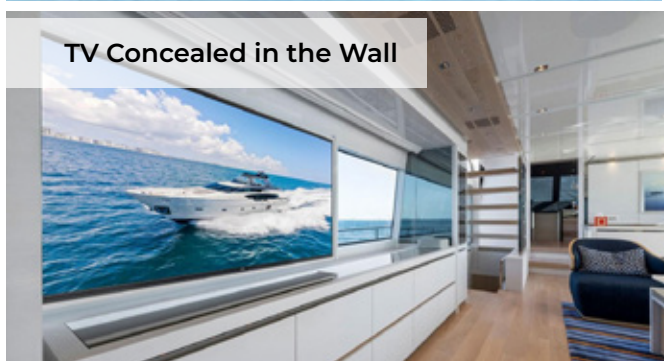

Panels System



# Home Collections



The Most complete and innovative range of Products dedicated to the home interiors

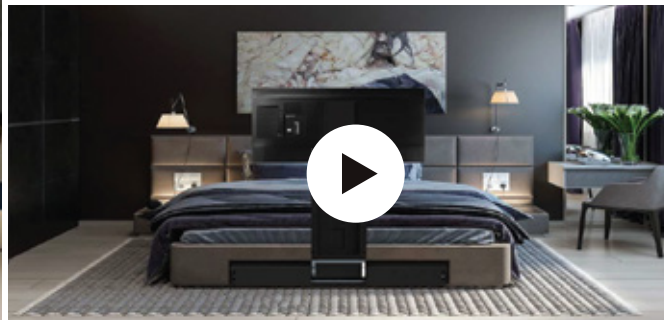

TV Lifts



Rotating TV Mounts



Flip Down TV



Wall Brackets

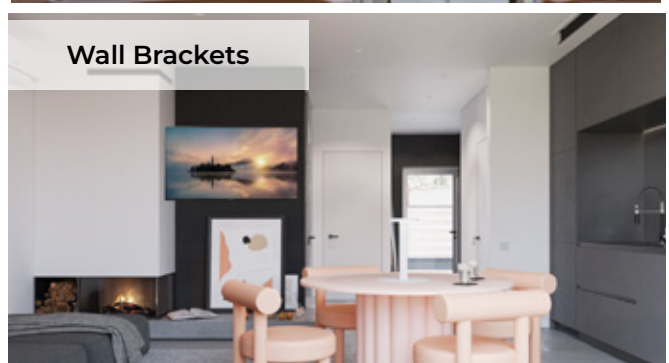

Panels System

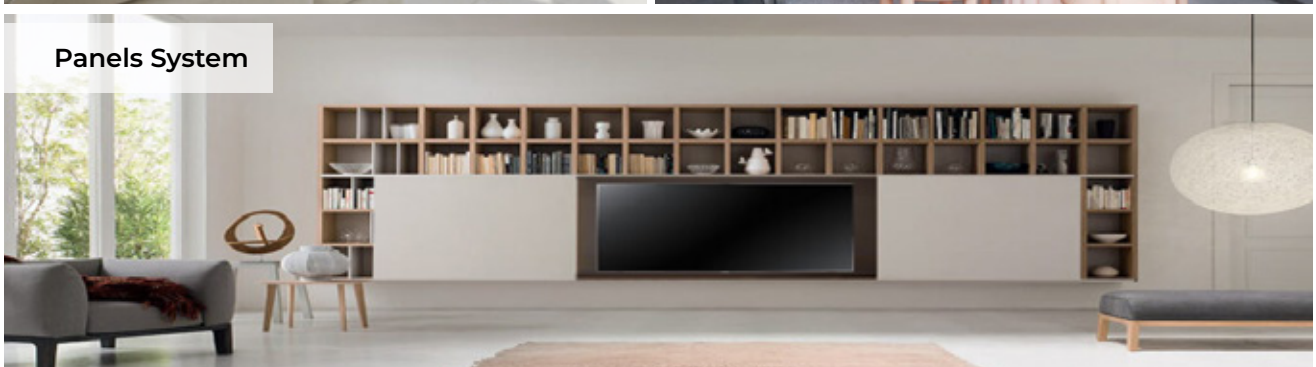

## EasyWay



EasyWay is a gangway entirely made of carbon fiber using an advanced method known as 'Oneshot', which allows for a monolithic structure without adhesives. The EasyWay gangway stands out for its hollow carbon fiber structure, making it incredibly lightweight, high-performing, and capable of floating. It not only provides superior performance but also significant fuel savings, as its reduced weight does not burden the boat.



# Design Build Aluminum

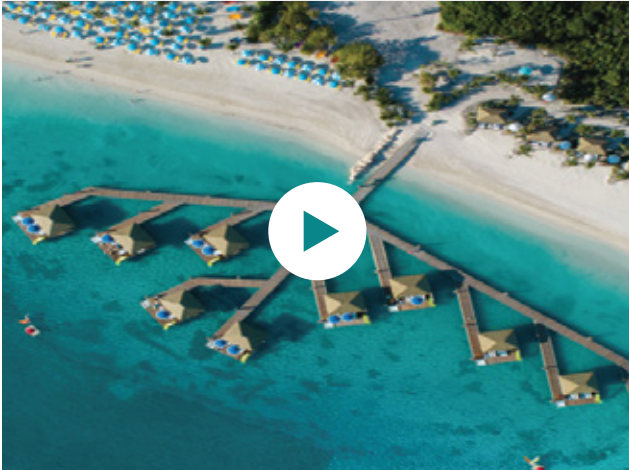

The Group has specialized in structural design and building using hardwearing aluminum that lasts decades. Constantly innovating to maximize efficiency, our structures are maintenance-free and optimize aluminum's sustainable benefits to create products that contribute to a more eco-friendly environment.

**Floating Docks**



**Gangways**



**Floating Wave Attenuators**



**Pedestrian Bridges**



**Tactical & Emergency Bridges**



**Aluminum Bridge Decking**



## Beach Cleaning Machines / Services



## Inflatable Water Products

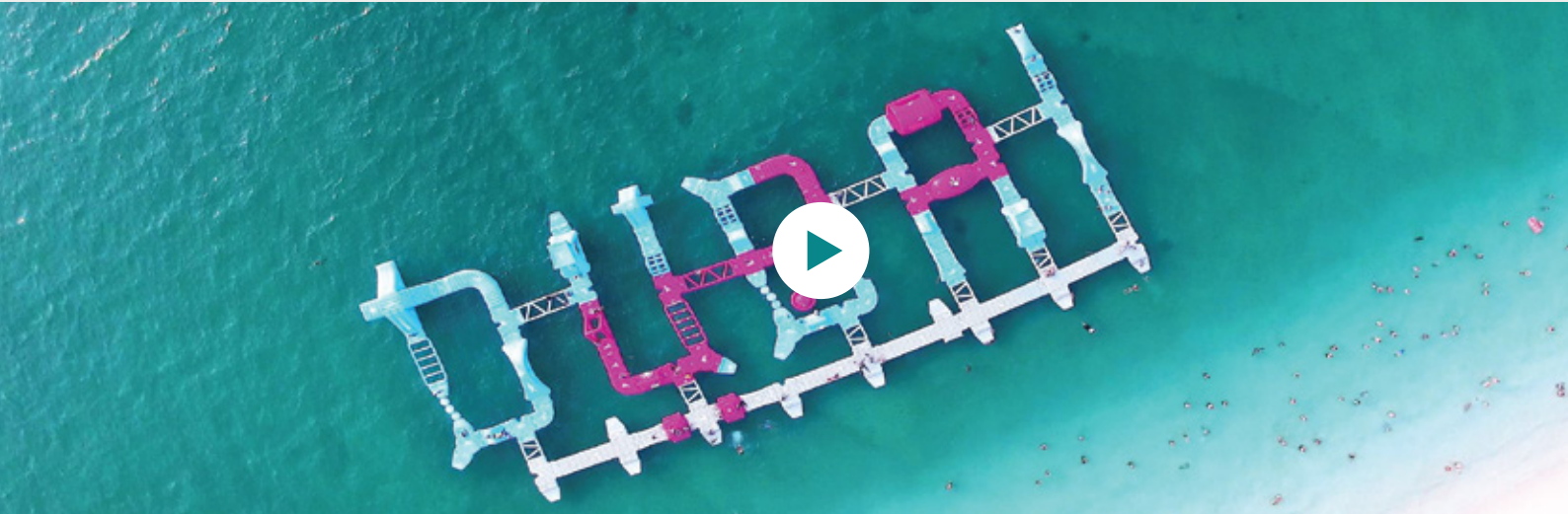

Wibit is a global leader in inflatable water park solutions, headquartered in Germany with over 25 years of industry expertise. They pioneered the modular floating water park concept and have delivered fun and safe aquatic experiences to over 70 million users in more than 100 countries. Known for their TÜV-certified products, patented systems, and commitment to safety, Wibit offers fully customizable layouts for pools, lakes, and open waters. Their focus on innovation, quality, and long-term partnerships makes them a trusted name in aquatic entertainment worldwide. Wibit brings exceptional value through reliable support, creative solutions, and proven performance.

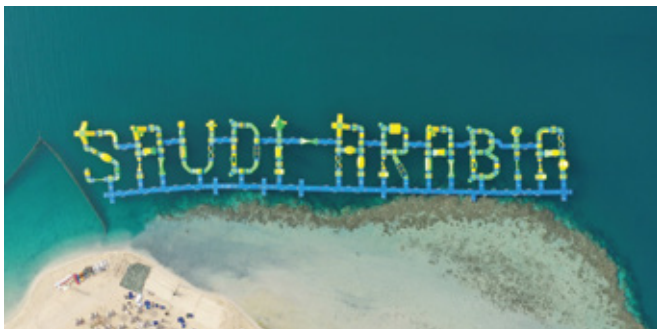

## Sports Park

## Inflatable Water Products



Sports Parks are modular, customizable inflatable water parks designed to suit any location, size, or visitor capacity. Using their Perfect Fit Configurator, Wibit tailors each layout for optimal safety, flow, and user experience. Innovative features like InfinityLoops, RouteFinder, and the Step-Up System ensure smooth movement and inclusive fun. Backed by TÜV-certified German engineering, each park offers a safe, engaging, and profitable attraction with full branding and design support. With options ranging from compact setups to large-scale installations, Wibit SportsParks deliver unforgettable aquatic experiences for all ages.

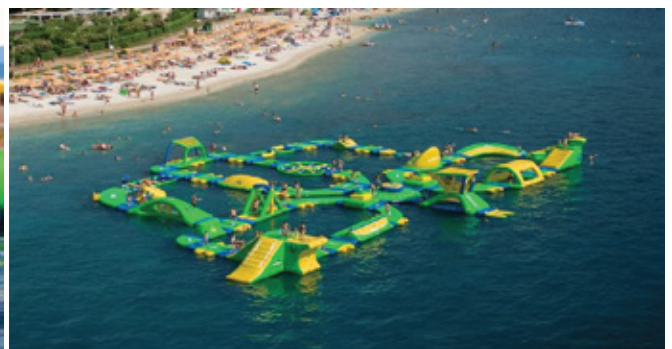

## Pool Track

## Inflatable Water Products



Pool Tracks transform pools into dynamic inflatable obstacle courses ideal for hotels, resorts, and commercial pools. These TÜV-certified modular tracks like AquaTrack, FastTrack, WiggleTrack, and BalanceTrack are fully customizable in layout, color, and branding to fit any pool shape or guest demographic. Designed for all ages and fitness levels, they encourage healthy, playful movement while maximizing space and fun. With German-engineered quality, in-stock availability, and a three-year warranty, PoolTracks offer operators a safe, profitable, and engaging pool-based entertainment feature

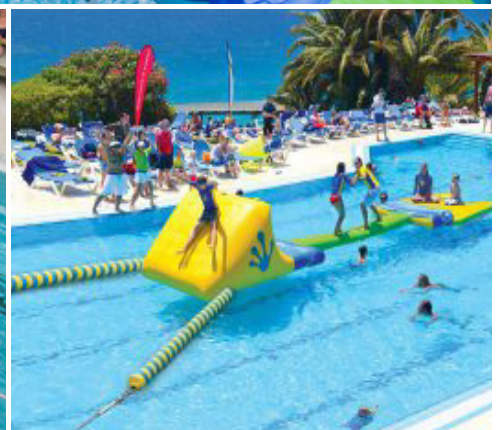
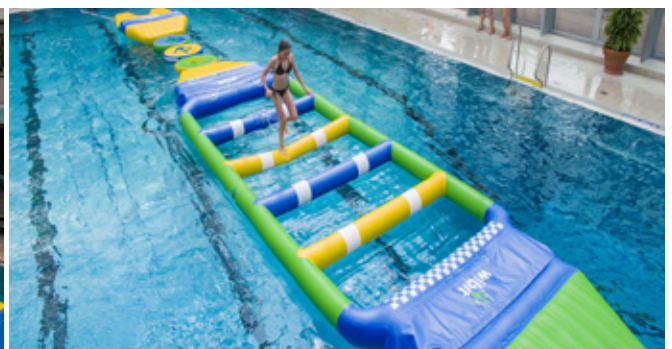

## kids Park

## Inflatable Water Products



Kids Parks are inflatable obstacle courses designed specifically for young swimmers aged 4 and above (approximately 1.00–1.50m tall) and are perfect for shallow-water areas. With Infinity Loops ensuring endless routes without bottlenecks and a user-friendly Step-Up System allowing seamless re-entry after a splash, these setups maximize playtime and fun for little adventurers. Compact, easy to handle, and safe to install. Ideal for smaller beaches, lakes, or pools, they accommodate around 20–30 kids per session and come equipped with lifejackets, easily stored modules, and installation accessories

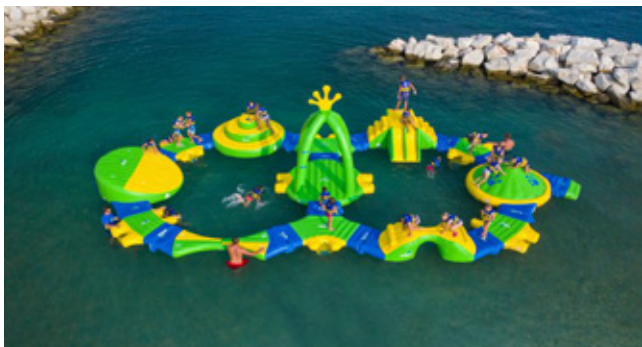

## Wibit TAG

## Inflatable Water Products



WibitTAG is a pioneering floating signage system that transforms any water location into a giant, readable message using modular components to form letters, numbers, or symbols visible from above. It allows resorts, cities, brands, or operators to “say it on the water,” creating a striking visual identity with high-impact from land and air. For example, the iconic “DUBAI” TAG installed at Jumeirah Beach Residence used nearly 100 modules in Dubai’s official colors and thrilled up to 200 people at once while generating viral aerial imagery. Designed both as a playable attraction and a communicative landmark, delivers exceptional engagement, branding, and social media visibility .



# Looft

## Inflatable Water Products



Looft by Wibit is a premium sub-brand designed to elevate the water leisure experience through sophisticated floating relaxation solutions. Looft modules seamlessly complemented action-packed aquatic attractions with luxurious floating platforms, cabanas, and a pool surrounded by couches, offering a serene oasis for guests. Meticulously engineered to blend elegance with durability, Looft spots redefine comfort on the water, delivering a high-end, cohesive experience alongside Wibit's dynamic sports installations. This blend of relaxation and innovation makes Looft a standout addition to any upscale waterfront destination.





**Ras Al Khaimah, UAE** PO Box 12353 T: +971 7 221 5211

**Dubai, UAE** PO Box 33591 T: +971 4 268 5855 | **Abu Dhabi, UAE** PO Box 46260 T: +971 2 671 7414

info@arkimarine.com | www.arkimarine.com